

INSTALLATION AND CARE GUIDELINES

- Cabinets must be attached to wall studs with screws, not nails, for full support.
- Check each cabinet as it is installed to ensure that it is level and plumb. Sand or shim where needed. Remove baseboard and chair rails from behind cabinets for a flush fit.
- To protect cabinets, do not remove them from cartons until ready to be installed. Never use an installed cabinet as a workbench.
- To protect the finish, wipe up spills promptly. Clean occasionally with a soft, damp cloth and dry immediately. Use no abrasives. Wax periodically with a liquid wax.
- Avoid such unnecessary moisture as towels draped over doors and steaming coffee machines under cabinets. Place appliances carefully so as to avoid unnecessary extremes of temperature.
- Do not swing on or slam doors or drawers. Do not overload shelves. Use bumper pads provided to absorb the impact of closing and protect against splitting of doors.

Beginning Installation

- Always install with 2-1/2" or longer wood screws. Never use nails.
- Always begin with a base corner cabinet and alternate cabinets to each side.

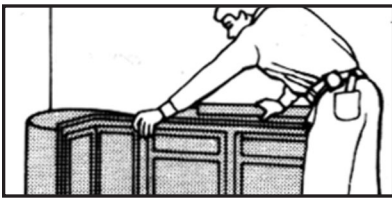

Start base cabinets in corner

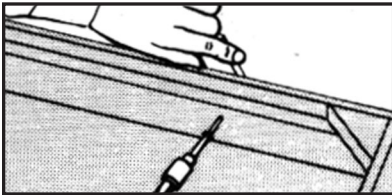

Attach to wall studs

- Use "C" clamps to obtain proper alignment when connecting cabinets. Secure with T-nuts and 1/2" bolts through end panels and adjoining cabinets, or drill and screw through the stiles of the face frame.

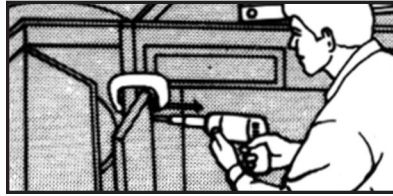

Use "C" clamps to align

- To prevent backrail from bowing, install a block between cabinet back and wall.
- After base units are installed, cover toe-kick with optional material. Attach counter tops and cover with cartons for protection.
- Begin wall cabinets with a corner unit. From inside, screw through hanging strips at back of cabinets 3/4" above bottom shelf and 3/4" below top shelf. Adjust loosely.

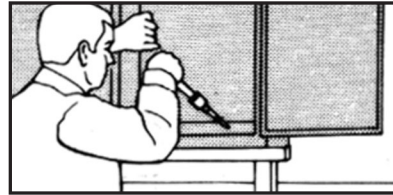

Start wall cabinets in corner

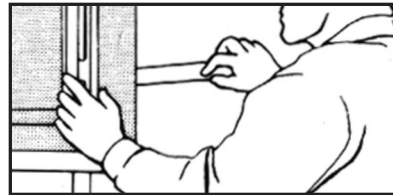

Use shims as needed

- After aligning, tighten all screws.
- After installing adjustable shelves in desired position in double door cabinets, mark a line at bottom center of each shelf on the inside back wall of the cabinet. Remove shelves and drill 1/4" hole 3/16" below each line on the inside back wall of the cabinet. Install shelf support in back and front stiles and replace shelf.

Notes

